



## Quick START GUIDE

# ATG e-Power app



**ATG Electronics, Inc.**

10588 Monte Vista Ave, Montclair, CA 91763

+1-951-245-6222

[service@atgelectronics.com](mailto:service@atgelectronics.com)

<https://www.atgelectronics.com/>



## Table Of Contents

<b>Quick Start Guide</b> .....	02
<b>1. App Installation</b> .....	03
<b>2. Account Management</b> .....	03
1) Register Account and Login.....	03
2) Register an Email Account.....	04
3) Forgot Password.....	04
4) Change the Password.....	05
5) Change Personalize Name and Remove Account.....	05
<b>3. EV Charger Management</b> .....	06
1) Add EV Charger.....	06
2) Wi-Fi Configuration.....	07
3) Other Configuration (Firmware Upgrades etc.).....	08
4) Rename Your Chargers.....	09
<b>4. Charging Interface</b> .....	10
1) Charging Process.....	10
2) Scheduling Charge.....	11
3) Energy Rate Setting.....	11
4) Charging Data Statistic Report.....	12

## Quick Start Guide

Once installed, a **ATG e-Power charger** is straight away ready for use. However, we recommend following this **Quick Start Guide** to maximise its full potential and use all its intelligent functionalities with the **ATG e-Power app**.

Complementary to this guide, you can consult our help content on the [ATG Support website](#).

# 1 App Installation



Please scan the QR code to download and install the latest version of the "EV iConnect" App.



# 2 Account Management

## 1 Register Account and Login

Support 3 types of account login:

- 1 Email
- 2 Apple ID
- 3 Google ID

Register with email address for email login.

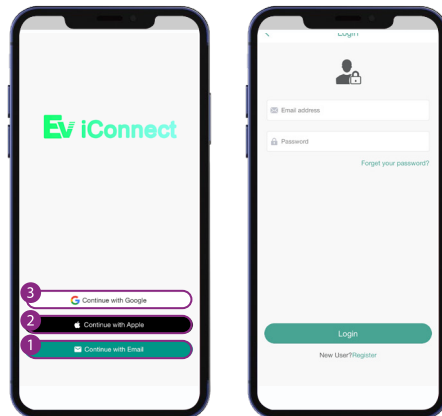

## 2 Register an Email Account

- 1 Click "Register" button.
- 2 Enter name, email address and password, then click the "send" button for verification code. Receive the "verify code" from your email and enter it to "code" section.
- 3 Click mark on the "Privacy Policy" and "Term of Service".
- 4 Click "Register" to complete the process.

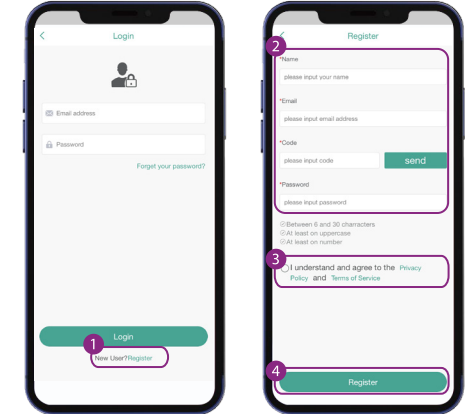

## 3 Forgot Password

If you forget your password, follow the below steps to retrieve your login information.

- 1 Enter the email address, click "send" button to get verification code send to your email. Then enter the verify code to the "code" section.
- 2 Once the verify code submitted on the app, login information will send to your email.
- 3 Now you can use the retrieved account information to login to the App.

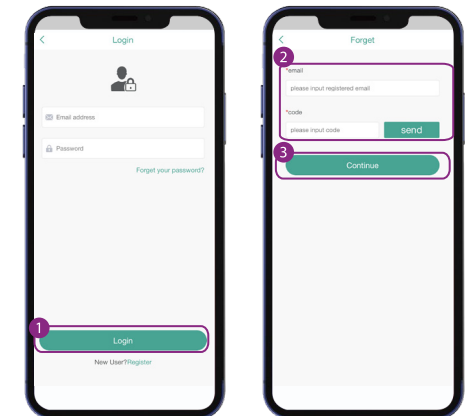

## 4 Change Password

If you want to Change Password, follow below steps:

- 1 Click the "👤" icon at the upper left corner on the App.
- 2 Click "Change Password".
- 3 Enter your password in the "Change Password" menu.
- 4 Click "continue" to complete update the password.

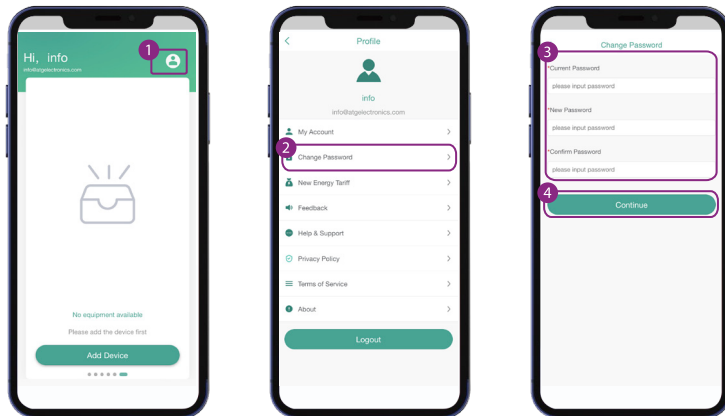

## 5 Change Personalize Name and Remove Account

- 1 Click the "👤" icon at the upper left corner on the App.
- 2 Click "My Account"
  - A Change personalize name: enter new personalized name, then click "continue".
  - B Remove account: click "delete my account".

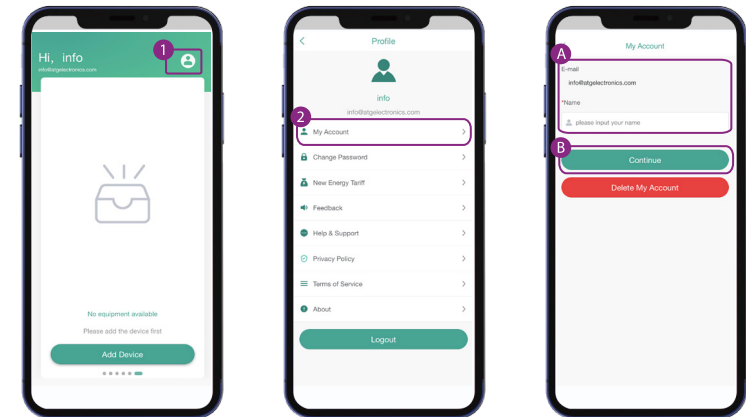

## 3 EV Charger Management

### 1 Add EV Charger

Three methods to add new EV Charger unit

- 1 Bluetooth
- 2 Manual input
- 3 Scan the QR code on the product

- 1 Add EV Charger via Bluetooth
  - A Click the "Add Device" on the App.
  - B Choose the unit "CCID" number from the list to add a new EV Charger.

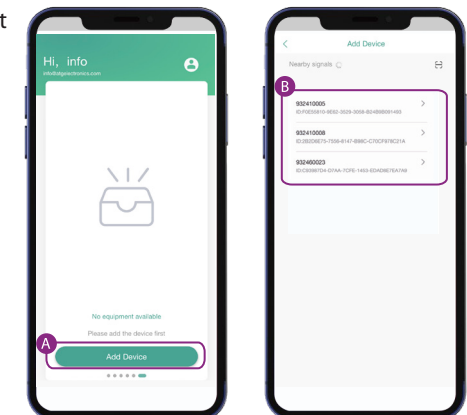

## 2 Add EV Charger via Manual Input

Enter the new unit "CCID" number in the "Manual Input" window, then click "OK" to add.

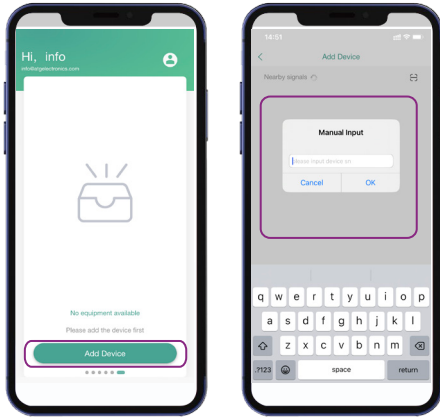

## 3 Add EV Charger via QR Code

Click the "QR" icon on the App, scan the QR code from the EV charger to add.



## 2 Wi-Fi Configuration

Configure the Wi-Fi on the EV charger, select your Wi-Fi from the "Wi-Fi list", then enter the Wi-Fi password to configure.

Once finish the Wi-Fi configuration, you will find the EV charger listed in the home page of the App.

- Wi-Fi indicator is green: connecting successful.
- Wi-Fi indicator is gray: connecting unsuccessful.

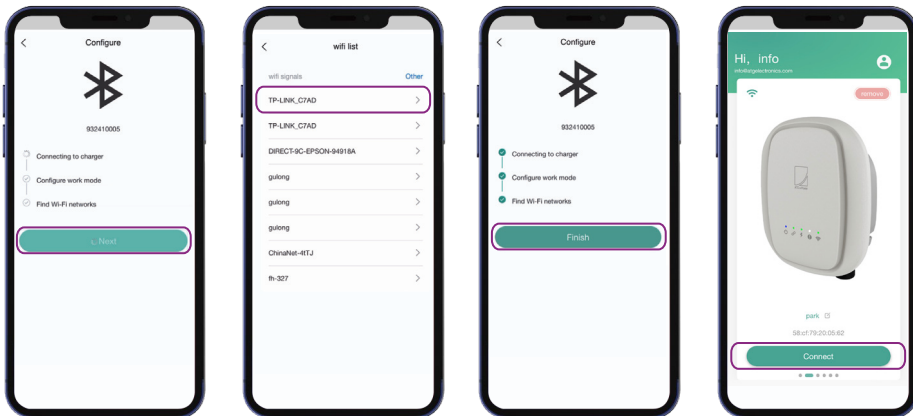

## 3 Other Configuration (Firmware Upgrades etc.)

- 1 By clickon "⚙️" on the upper right corner, you will able to access the configuration page to change the following configuration.
- 2 Firware upgrade: only support upgrade when Wi-Fi is connected.
- 3 Wi-Fi connectivity: if your Wi-Fi setting changed, you need to reconfigure Wi-Fi setting. Please be sure the bluetooth is connected.
- 4 Switch to "Plug and Charge" mode.
- 5 Card Management: click "Add Card" to add RFID card to the unit.

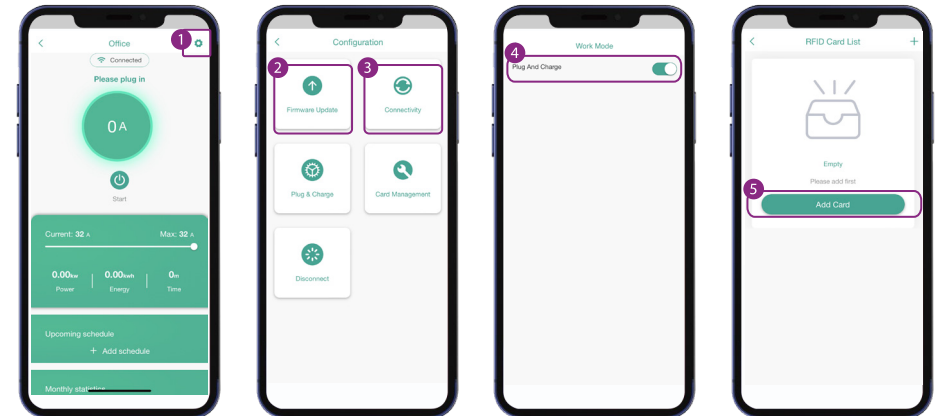

## 4 Rename Your Chargers

Click the "i" icon. Enter a new unit name in the "Change Alias" window, then click "OK" to complete rename the unit.

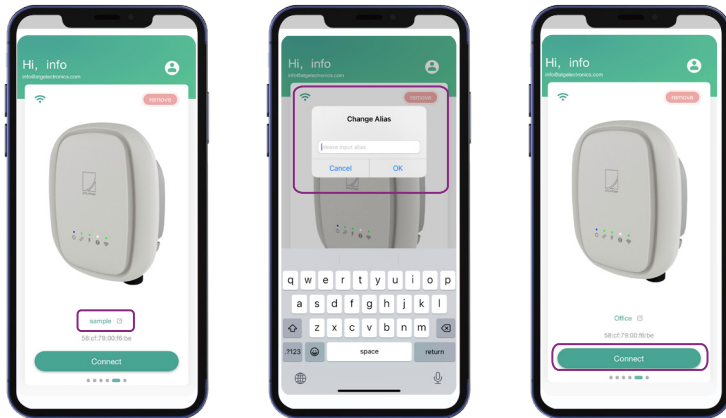

## 4 Charging Interface

### 1 Charging Process

- 1 Plug in the charger gun to the car.
- 2 Click "Start" to start charging after charging status become "Ready" in the App charging interface.
- 3 Click "Stop" to end the charging process when it is completed.

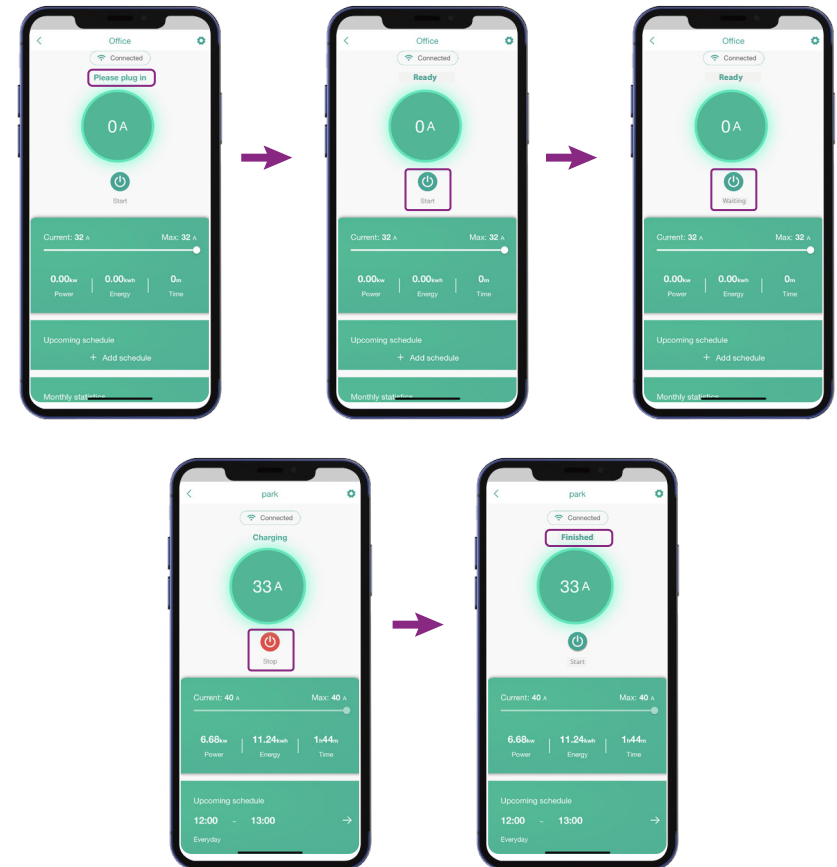

## 2 Scheduling Charge

- 1 Click "+ Add schedule" in the charging interface.
- 2 Select the "start time" and "end time" in the scheduling window, then select the schedule cycle, then click 'SAVE' to complete schedule setting.

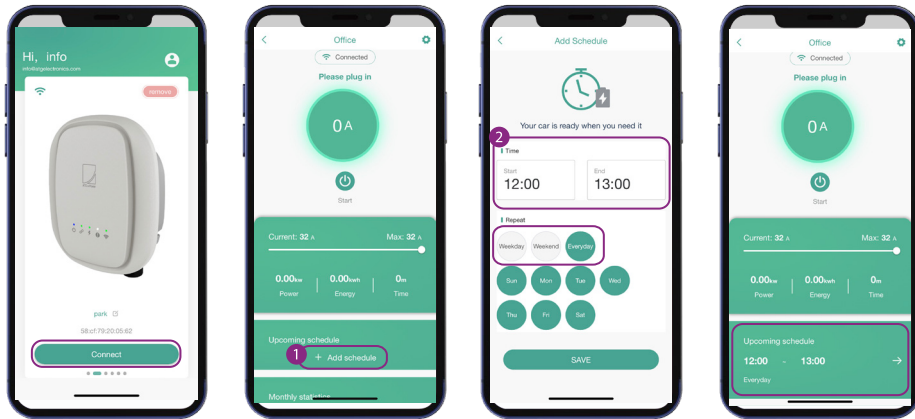

## 3 Energy Rate Setting

- 1 Click "⚙️" icon on the upper left corner on the App.
- 2 Click "New Energy Tariff".
- 3 Enter the energy unit rate with the corresponding time frame in the "New Energy Tariff" window.
- 4 Click "Save".

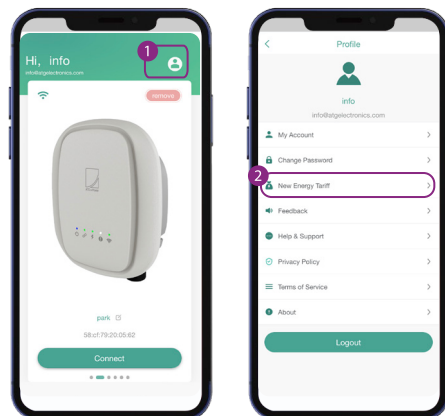

## 4 Charging Data Statistic Report

- 1 Review the statistics of the charging data by weekly monthly and annually in addition to the latest charging record.
- 2 Click "View History" to view charging record details.

